

CONFORM WALL

WALLBOARD FASTENED WITH
#6x1" BUGLE HEAD DRYWALL SCREWS
SPACING AS REQUIRED

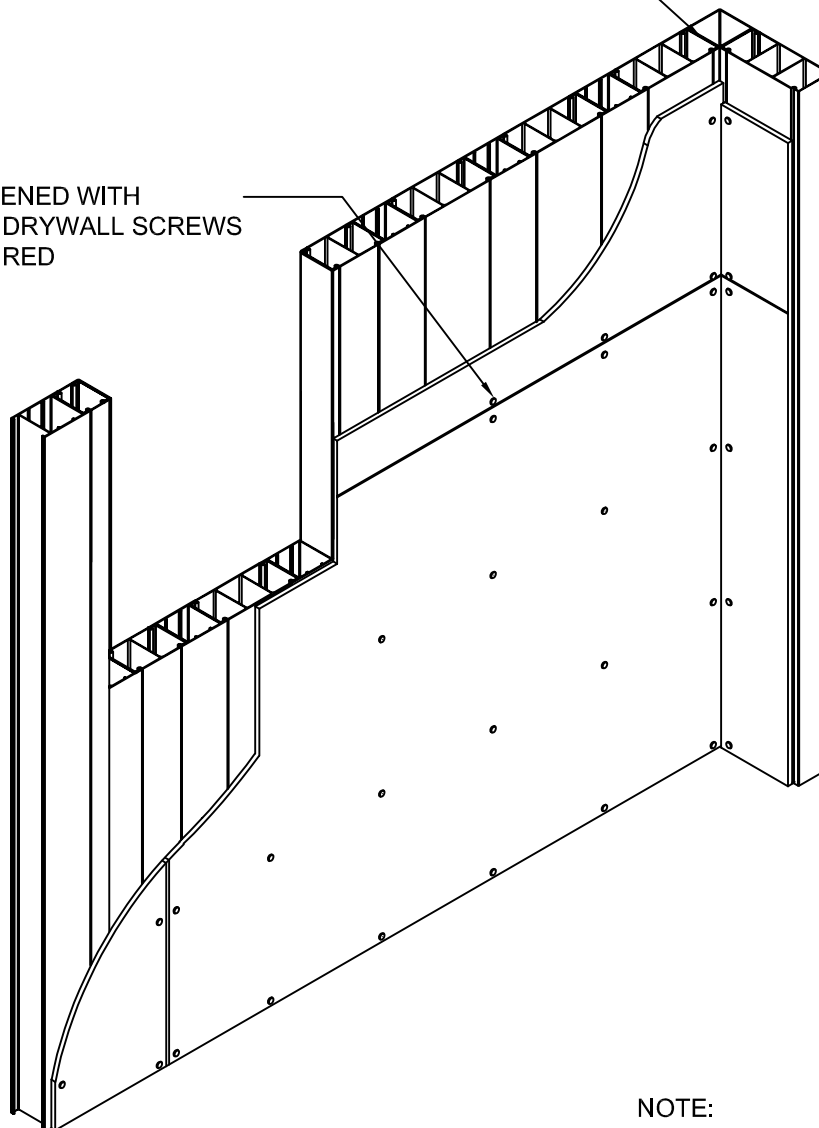

NOTE:

INSTALL SCREWS WHILE CONCRETE
IS GREEN OR USE CONCRETE
SCREWS IN DRILLED HOLES.

- DETAIL FOR FORMWORK ONLY
- ALL DETAILS, REINFORCING STEEL & CONCRETE MUST
BE DESIGNED & CONFIRMED BY PROJECT STRUCTURAL
ENGINEER AND / OR PROJECT ARCHITECT.



Nuform Building Technologies Inc.
100 Galcat Drive, Unit #2,
Woodbridge, Ontario, Canada L4L 0B9
Tel: 905-652-0001 Fax: 905-652-0002
Toll Free: 1-877-747-9255
Web Page: www.nuformdirect.com

CONFORM WALL - GYPSUM WALL BOARD



DRAWING NO.

A311

COPYRIGHT 2024

SCALE:

REVISION No.:

R00