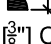

FLASHING

N.T.S.

6

APPLY 10mm [$\frac{3}{8}$ "] CONTINUOUS CORNER BEAD  10mm [$\frac{3}{8}$ "] OF SEALANT AND 10mm [$\frac{3}{8}$ "] CONTINUOUS FLAT BEAD OF SEALANT ON TOP OF FLASHING AT INSIDE FACE OF FLASHING.

5

10mm [$\frac{3}{8}$ "] CONTINUOUS FLAT BEAD OF SEALANT ON TOP OF FLASHING AND ON INSIDE LEG OF FLASHING, AT EACH END OF FLASHING.

7

APPLY 10mm [$\frac{3}{8}$ "] FLAT BEAD OF SEALANT AROUND PRE-DRILLED HOLES FOR SCREWS.

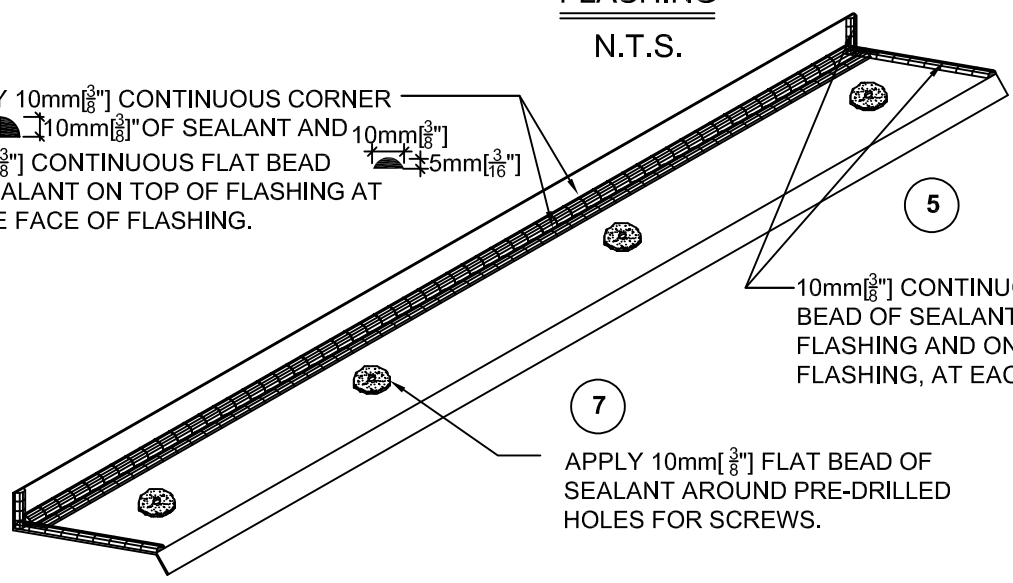

HEADER SECTION

CONCRETE WALL WITH CONFORM.

DO NOT APPLY SEALANT ABOVE FLASHING.

16 GA GALVANIZED FLASHING WITH PREDRILLED HOLES FOR SCREWS AT CENTERLINE OF CONCRETE.

8

SECURE FLASHING WITH FLAT HEAD CONCRETE SCREWS AT 50mm [2"] FROM EACH END AND 333mm [1'-1 $\frac{1}{8}$ "] o/c MAX.

7

SEALANT AROUND HOLES FOR SCREWS.

6

CONTINUOUS CORNER AND FLAT BEADS OF SEALANT AT TOP OF FLASHING AT INSIDE FACE OF HEADER.

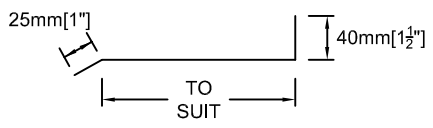
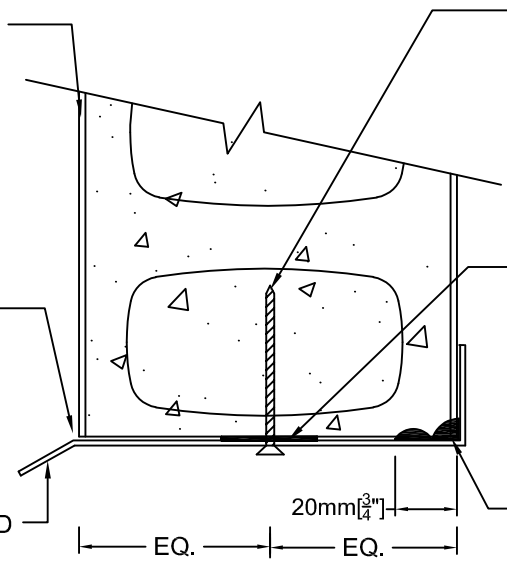

- DETAIL FOR FORMWORK ONLY
- ALL DETAILS, REINFORCING STEEL & CONCRETE MUST BE DESIGNED & CONFIRMED BY PROJECT STRUCTURAL ENGINEER AND / OR PROJECT ARCHITECT.



Nuform Building Technologies Inc.
100 Galcat Drive, Unit #2,
Woodbridge, Ontario, Canada L4L 0B9
Tel: 905-652-0001 Fax: 905-652-0002
Toll Free: 1-877-747-9255
Web Page: www.nuformdirect.com

**CONFORM WALL OPENING
-HEADER FLASHING**



DRAWING NO.	
A092	
COPYRIGHT 2024	
SCALE:	REVISION No.:
	R00