



# CONFORM™

## The Revolutionary Stay-in-Place Concrete Wall Forming System

**CONFORM™** is a patented polymer-based stay-in-place formwork for concrete walls. The extruded components slide and interconnect together to create a concrete formwork. The result is permanent, attractive and maintenance free pre-finished walls designed...





# CONFORM™

## An innovative, cost-efficient & time-saving alternative to conventional construction.

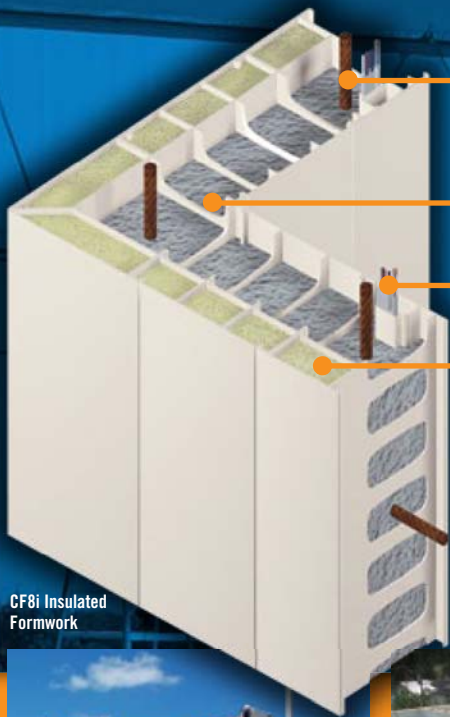

REBAR  
(if required)

CONCRETE

ELECTRICAL/DATA SERVICE CHANNEL

INSULATION

Providing a minimum effective R-value of 22

CF8i Insulated Formwork

Also available in 4" (100mm), 6" (150mm) and 8" (200mm) non insulated formwork



1. Wall Erection



2. Bracing



3. Concrete Pour



4. Completed Walls

**Rigid polymer forms easily slide together, creating durable pre-finished walls that can be constructed quickly in any climate.**

# CONFORM™: engineered to perform in the most challenging conditions.

- **Durable**
- **Energy efficient**
- **Maintenance-free**

## **New vehicle-wash buildings, built from the ground up.**

- > CONFORM™ will lower your initial construction costs and thanks to its virtually maintenance-free performance, it also eliminates refinishing costs at reload time
- > Walls do not discolor, fade, stain, rust or corrode
- > No mold and mildew built-up
- > Also can be used for retaining walls, garbage enclosures, vacuum islands and pet washes
- > Use REVIVE as a part of your routine maintenance program; for tougher stains use our Graffiti Remover

## **Ideal for all types of Agricultural facilities.**

- > Superior energy performance keeps animals healthy and lowers operating costs
- > Mold and mildew resistant finish improves indoor air quality
- > Walls can be quickly and easily washed down to maintain strict cleanliness demanded in today's modern agricultural facilities

## **A cost effective alternative for Commercial & Industrial buildings.**

- > Rapid construction
- > Superior energy performance keeps operating costs low
- > Bright, clean inside wall finish and superior indoor air quality
- > Long term durability
- > Can be used for load bearing and non-load bearing walls
- > Ideal for large scale projects



**Vehicle Washes**



**Agriculture**



**Commercial / Industrial**





# The perfect finish.

RELINE™ when used as a ceiling panel, is the perfect complement to a CONFORM structure and the ideal choice for renovating existing facilities. Easy to install using a wide range of optional accessories and trim components, RELINE makes it easy to finish walls and ceilings in new construction or for renovations throughout the building.

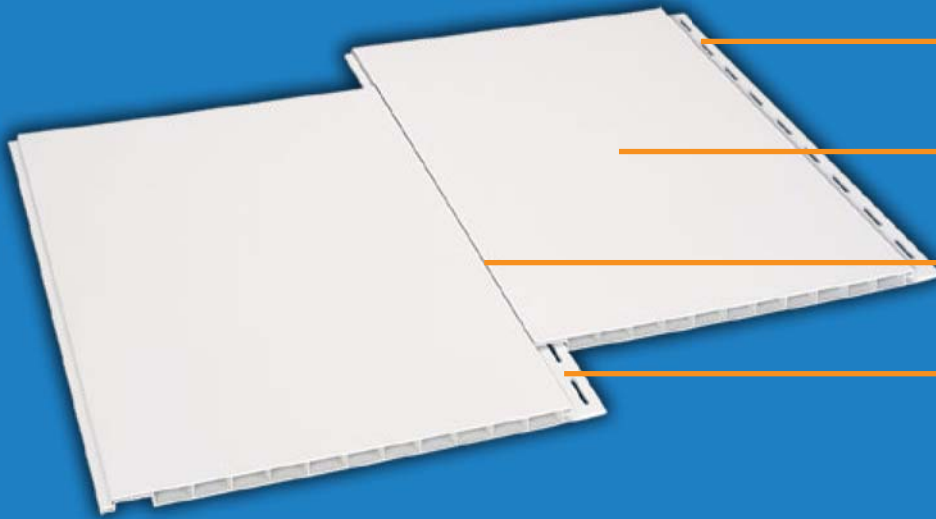

- Concealed fasteners for a clean finish
- Durable, smooth surface for minimal maintenance
- Interlocking fastening system for quick and easy installation
- Heavy Duty slotted fastener leg to accommodate expansion and contraction

Available in Bright White and NUFORM White

## Our commitment.

### RECYCLE › REUSE › REPURPOSE

Nuform Building Technologies Inc. is committed to the promotion of building greener, more environmentally friendly building structures. We don't just talk about a greener future, we actually live it every day, and it is at the core of our manufacturing process using

R3 Sustainable Extrusion Technology.



SUSTAINABLE  
EXTRUSION  
TECHNOLOGY

- › NUFORM™ has over 15 years of proven, in the field performance using recycling process technology
- › High quality bi-extrusion process creates fused products that do not peel, flake or delaminate providing a consistent appearance and performance
- › Provides contributions toward LEED points
- › Highly mold and mildew resistant (as per ASTM G21) along with low VOC emissions lead to healthier interior environments
- › Reduced on-site painting and finishing thereby minimizing the use of more hazardous products
- › Excellent light reflective properties promotes lower building energy costs
- › Increased durability, long life cycle and low maintenance provide for sustainable building envelopes



#### Nuform Building Technologies Inc.

100 Galcat Drive, Unit #2  
Vaughan, Ontario, Canada  
L4L 0B9  
Toll Free: 1 877 747-WALL (9255)  
Tel.: 905 652 0001

[www.nuformdirect.com](http://www.nuformdirect.com)

[www.nuformdirect.com](http://www.nuformdirect.com)